

TAKING MEASUREMENT FOR YOUR KIT



FLAT ROOFED STRUCTURES

Instructions when your Verandah, Patio or Carport is to be *attached to another existing structure*.

Normally this attachment might be your home.

If please so fill in below.

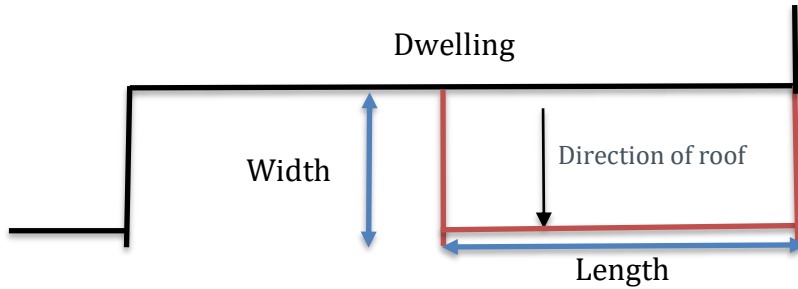

Width :

The width is what your project will come out from your dwelling.
Flat Roofed structures are measured from outside of fascia (or wall) to outside of side beam.

Firstly, what do you propose to attach to: Please tick your situation.

1. Fascia or
2. Wall Please advise type of wall masonry / weatherboard / other.....

If Fascia, is your fascia made of metal or timber

1. Timber or
2. Metal

This measurement example assumes the roof will run away from dwelling

How to establish your width:

Measure from your wall to where project will finish the Deduct width of eave to calculate actual width of project.

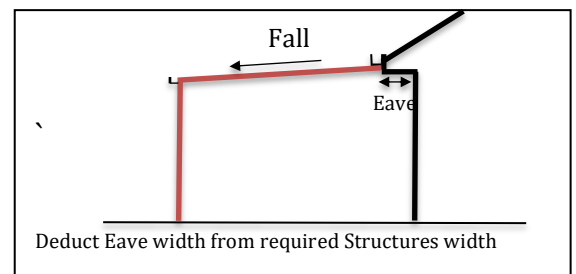

If connecting to dwelling, please advise the pitch of your existing dwelling (Home) roof) - 17.5° 22° 25° 30° other -
circle your home roof pitch

Note: Centenary Kits only come in 1° 2° & 5° - please circle your choice of pitch

If attaching directly to a wall, then just simply measure the width from the wall.

Please advise width: mm (ie: 3250mm)

Length:

Measure the length along the dwelling (which the verandah will fasten to).

Please advise length: mm (ie: 7250mm)

Outdoors Project Supplies – Leaders in Quality Outdoors Products

52 Star Crescent
Hallam Vic. 3803
Telephone: (BH) 03-9704 4900



TAKING MEASUREMENT FOR YOUR KIT



FLAT ROOFED STRUCTURES

Height:

Measure from directly the under actual gutter to ground (or concrete) – check both ends of project length to establish (ensure) if height remains same. If different please advise both heights.

Please advise Height here: mm (ie 2450mm)

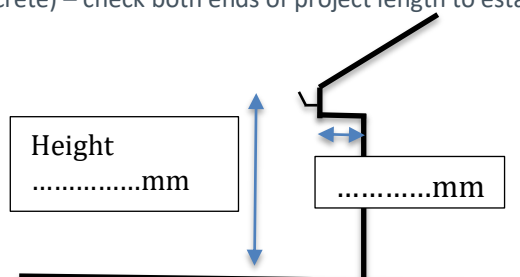

Ground surface:

Please advise what surface your project will sited above.

Your kit will be supplied to suit your ground situation.

Note: different ground connectors are supplied dependent upon your ground surface.

Please tick what surface you have

Concrete Surface: Decking Sub-floor: In ground connection:

IF CONCRETE CONNECTORS:

If connecting to concrete – bolt down stirrups are supplied for attachment to existing 100mm concrete reinforced slab. It is important to ensure concrete is suitable for project. (*seek qualified assistance to confirm acceptability prior to ordering kit or installation*)

Note: Dyna bolts or other fastening options to concrete or a deck are not supplied with kits. Kit instructions will provide product recommendations (options) for suitable fastening products.

POSTS IN-GROUND STIRRUPS:

If a pad footing is your project option ie: your stirrups are going to be concreted* into ground, then In-ground connectors will be supplied.

Note: posts for in ground connection have stirrups to provide increased ground contact durability. Our posts do not go directly into ground, unlike other manufacturers, due to the low durability of colorbond with direct contact to ground for long periods.

Note: Concrete is not supplied for concreting around stirrups. Check your Kit instructions for pad footing size for your specific project.

DECKING SUB-FLOOR:

Under some situation's verandah post connection to a decking sub-floor is possible.

Please confirm this to our staff who will discuss your options if this required.

Note: Inspection by a qualified builder / practitioner to confirm suitability of your deck for Verandah attachment should be considered prior to ordering kit &/or installation.

Dwelling Attachment:

All attached DIY Kits assume that the project is coming from the fascia or suitable wall of the dwelling or alternative as advised.

Note: Buyers care to ensure suitability and condition of these surfaces. These need to be accessed prior to ordering Kit &/or installation

Please advise us if you're coming from metal fascia, masonry wall or timber fascia as this can change attachments included in your kit.

Outdoors Project Supplies – Leaders in Quality Outdoors Products

52 Star Crescent
Hallam Vic. 3803
Telephone: (BH) 03-9704 4900



TAKING MEASUREMENT FOR YOUR KIT



FLAT ROOFED STRUCTURES

If coming from brick (masonry) wall or some other attachment you will need to advise us so the right attachment fitting is included.

Some variations can apply to attachment methods required so this information is important.

SITE CHECK MEASURE INSPECTION:

Should you require a check measure inspection this is available in Melbourne metro area for a fee of \$350.00 – non-refundable and is extra to Kit purchase price.

ADVICE, PERMITS AND PREPARATION:

It is our wish that the purchase and installation of your DIY Colorbond Kit is successful and a valued addition to your home.

We advise you to consider and ensure: -

- As there are Australian Standard Building requirements needed to be met, it is important that advice and assistance from suitability qualified builder / practitioner to review your site prior to building and ordering your Kit is undertaken and possibility during installation.
- A Building Permit is normally required for a roofed structure. You can confirm this via your local council or a registered building surveyor.
- Check with your council if any planning permits required.
- As you are the Builder please double check your measurements to ensure they correct. Please also ensure confirmation measurement provided by us correspond to your measurements prior to ordering Kit.

Note: As Kits are custom made confirmed measurements are vital to ensure correct sized material is provided. To ensure errors do not occur we request you ensure our order confirmation is the same as your measurements and colour requested.

- All Victory Kits will come with project specific Engineering and a kit layout plan (of kit) that can be submitted along with your architectural plans to form part of your permit application. *Should any further information be required please contact our office?*
- If you wish to obtain a permit prior to ordering your Kit then a minimum \$350 deposit is required from the cost of your total Kit purchase price to secure the engineering.

Note: All signed engineering plans are forwarded (emailed) upon initial deposit being paid, this will take 7 days from deposit payment.

Disclaimer and Notice:

Outdoor Project Suppliers has prepared this information sheet, and is general in nature, to assist with ensuring the success of your project installation. Please recheck your measurement prior to purchase as no responsibility is taken from incorrect measurements and instructions. No concrete, masonry or deck connections, or stormwater products are included in kits.

If we provide an on-site inspection, then final measurement based on those site discussions, inspection and information provide by owner. It is Owner's responsibility to confirm measurements as to size, pitch, colours and location. Owner is to confirm written confirmation of these measurements and colours selected.

As DIY Kits installation remains the responsibility of owner / builder to provide measurement, attachment proposed & construct We cannot accept or take responsibility for incorrect installation, measurements or siting of a project.

We suggest consideration of a fully installed project by a qualified builder be considered. No storm water connection supplied beyond downpipes is standard to any kit supplied including concrete or masonry connections

All effort by Victory has been under taken to ensure Kits meet all Australian Building Standards and requirements. Refer to Victory web site for more Kit details and information brochures. www.victoryhomeimprovements.com.au

Outdoors Project Supplies – Leaders in Quality Outdoors Products

52 Star Crescent
Hallam Vic. 3803
Telephone: (BH) 03-9704 4900